



F1SL24 with compressor left, stainless door and top

PRODUCT INFORMATION

(see F1SL Spec Sheet for complete details)

STANDARD FEATURES:

- Self-contained
- All stainless steel interior construction
- Models with doors include three adjustable coated shelves per door
- Listed to NSF Standard 7

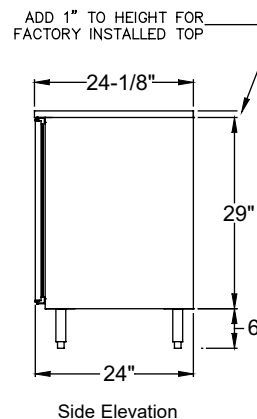

*NOTE: F1SL units are manufactured to order and are not returnable.

FROSTERS - ONE ZONE, SIDE SERVICED, LOW PROFILE*

MODEL	LIST	LENGTH	DOORS	DOOR				10 Oz.	6" HIGH
				OPENING	WEIGHT	AMPS	HP	MUGS	PINTGLASSES
F1SL24	\$7,089	24"	1	17.5" W	180#	5.0	1/3	101	72
F1SL28	\$7,314	28"	1	20" W	195#	5.0	1/3	123	75
F1SL36	\$9,410	36"	2	12" W	230#	5.0	1/3	171	115
F1SL44	\$9,859	44"	2	16" W	255#	5.0	1/3	231	151
F1SL48	\$10,093	48"	2	18" W	280#	5.0	1/3	261	169

Base price only. See below for configurable options.

ACCESSORIES

MODEL	DESCRIPTION	LIST
DIP-17	Drawer insert for fractional stainless pans, 17.5" door opening (pans not included)	\$258
DIP-18	Drawer insert for fractional stainless pans, 18" door opening (pans not included)	\$264
DIP-20	Drawer insert for fractional stainless pans, 20" door opening (pans not included)	\$287



DIP-18
Pans not included



Capable of storing specialty cocktail ice

Bar Refrigeration

*NOTE: F1SL units are manufactured to order and are not returnable.

Select Configurable Options:

VOLTAGE

120V/60HZ	No charge
220V/50HZ (export voltage)	\$307

REFRIGERATION COMPARTMENT LOCATION

Left	No charge
Right	No charge

REFRIGERATION COMPARTMENT COVER FINISH

Black vinyl-clad	No charge
Stainless steel	\$39
Jeweled stainless steel	\$232

DOOR/DRAWER OPTIONS

NOTE: Select options for EACH Door/Drawer Section

STYLE AND FINISH - PER SECTION

Door - Black vinyl-clad	No charge
Door - Unlaminated	No charge
Door - Stainless steel	\$48
Door - Jeweled stainless	\$252
Door - Laminated	\$288
Door - Glass, black vinyl-clad	\$734
Door - Glass, stainless steel	\$782
Door - Glass, jeweled stainless	\$986
Door - Glass, laminated	\$1,022
Drawers - Black vinyl-clad	\$2,381
Drawers - Unlaminated	\$2,381
Drawers - Stainless steel	\$2,429
Drawers - Jeweled stainless	\$2,633
Drawers - Laminated	\$2,669

DOOR HINGE LOCATION - PER DOOR

Left	No charge
Right	No charge

DOOR HANDLE - PER DOOR/DRAWER

Signature handle (doors only)	No charge
Pull-tab handle - stainless or black to match door; black for laminate	No charge
Tube handle	No charge

TOP STYLE

	24"	28"	36"	44"	48"
No finished top	No charge				
Stainless top	\$440	\$465	\$519	\$575	\$601
Drainboard top	\$725	\$772	\$869	\$962	\$1,011

4" HIGH STAINLESS SPLASHES

	24"	28"	36"	44"	48"
NOTE: Can only be ordered with stainless steel top					
Backsplash	\$161	\$170	\$186	\$200	\$206
Left side splash	\$161	\$161	\$161	\$161	\$161
Right side splash	\$161	\$161	\$161	\$161	\$161

LEFT SIDE FINISH

Black vinyl-clad	No charge
Stainless Steel	\$48

RIGHT SIDE FINISH

Black vinyl-clad	No charge
Stainless Steel	\$48

BACK FINISH

	24"	28"	36"	44"	48"
Galvanized steel	No charge				
Stainless steel*	\$365	\$377	\$404	\$431	\$446

*NOTE: Stainless steel back option also includes stainless steel sides.

LED LIGHTING STYLE

Bright white (7,000k), standard	No charge
Warm white (3,500k)	No charge
Amber (2,700k)	No charge
Blue	No charge

LEG AND STAINLESS STEEL KICK RAILS

NOTE: Legs are required if kick rails are ordered.

	24"	28"	36"	44"	48"
6" legs	\$204	\$204	\$204	\$204	\$204
Front kick rail	\$127	\$133	\$142	\$153	\$158
Left side kick rail	\$127	\$127	\$127	\$127	\$127
Right side kick rail	\$127	\$127	\$127	\$127	\$127

CASTERS

	24"	28"	36"	44"	48"
4-1/8" casters	\$182	\$182	\$182	\$182	\$182
2-7/8" casters	\$176	\$176	\$176	\$176	\$176
1-1/2" casters	\$310	\$310	\$310	\$310	\$310



Drawer pull-tab handle

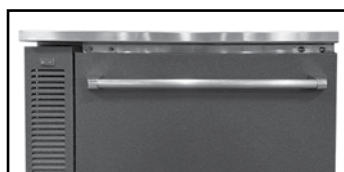

Drawer tube handle



Optional drawers include adjustable divider walls



Signature handle



Pull tab handle



Tube handle

Bar Refrigeration