



PRODUCT INFORMATION
(see F1SB Spec Sheet for complete details)

STANDARD FEATURES:

- Self-contained
- All stainless steel interior construction
- Models with doors include three adjustable coated shelves per door
- Listed to NSF Standard 7

F1SB48 with compressor left, stainless steel doors and top

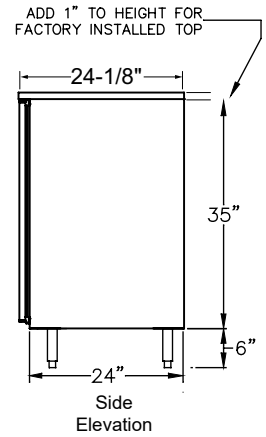

*NOTE: F1SB28, F1SB36, and F1SB44 frosters and all units with drawers are manufactured to order and are not returnable.

FROSTERS - ONE ZONE, SIDE SERVICED, BAR PROFILE

| MODEL | LIST | LENGTH | DOORS | DOOR OPENING | WEIGHT | AMPS | HP | 10 Oz. MUGS | 6" HIGH PINT GLASSES |
|---------|----------|--------|-------|--------------|--------|------|-----|-------------|----------------------|
| F1SB24 | \$7,142 | 24" | 1 | 17.5" W | 200# | 5.0 | 1/3 | 132 | 97 |
| F1SB28* | \$7,477 | 28" | 1 | 20" W | 220# | 5.0 | 1/3 | 160 | 100 |
| F1SB36* | \$9,780 | 36" | 2 | 12" W | 255# | 5.0 | 1/3 | 223 | 155 |
| F1SB44* | \$10,284 | 44" | 2 | 16" W | 280# | 5.0 | 1/3 | 299 | 200 |
| F1SB48 | \$10,543 | 48" | 2 | 18" W | 300# | 5.0 | 1/3 | 339 | 214 |

Base price only. See below for configurable options.

Bar Refrigeration

ACCESSORIES

| MODEL | DESCRIPTION | LIST |
|--------|---|-------|
| DIP-17 | Drawer insert for fractional stainless pans, 17.5" door opening (pans not included) | \$258 |
| DIP-18 | Drawer insert for fractional stainless pans, 18" door opening (pans not included) | \$264 |
| DIP-20 | Drawer insert for fractional stainless pans, 20" door opening (pans not included) | \$287 |



DIP-18
Pans not included



Capable of storing specialty cocktail ice

*NOTE: F1SB28, F1SB36, and F1SB44 frosters and all units with drawers are manufactured to order and are not returnable.

Select Configurable Options:

| VOLTAGE | |
|----------------------------|-----------|
| 120V/60HZ | No charge |
| 220V/50HZ (export voltage) | \$307 |

| REFRIGERATION COMPARTMENT LOCATION | |
|------------------------------------|-----------|
| Left | No charge |
| Right | No charge |

| REFRIGERATION COMPARTMENT COVER FINISH | |
|--|-----------|
| Black vinyl-clad | No charge |
| Stainless steel | \$39 |
| Jeweled stainless steel | \$232 |

DOOR/DRAWER OPTIONS

NOTE: Select options for EACH Door/Drawer Section

| STYLE AND FINISH - PER SECTION | |
|---------------------------------|-----------|
| Door - Black vinyl-clad | No charge |
| Door - Unlaminated | No charge |
| Door - Stainless steel | \$48 |
| Door - Jeweled stainless | \$252 |
| Door - Laminated | \$288 |
| Door - Glass, black vinyl-clad | \$734 |
| Door - Glass, stainless steel | \$782 |
| Door - Glass, jeweled stainless | \$986 |
| Door - Glass, laminated | \$1,022 |
| Drawers* - Black vinyl-clad | \$2,381 |
| Drawers* - Unlaminated | \$2,381 |
| Drawers* - Stainless steel | \$2,429 |
| Drawers* - Jeweled stainless | \$2,633 |
| Drawers* - Laminated | \$2,669 |

*NOTE: Units with drawers are manufactured to order and are not returnable.

| DOOR HINGE LOCATION - PER DOOR | |
|--------------------------------|-----------|
| Left | No charge |
| Right | No charge |

| DOOR HANDLE - PER DOOR/DRAWER | |
|--|-----------|
| Signature handle (doors only) | No charge |
| Pull-tab handle - stainless or black to match door; black for laminate | No charge |
| Tube handle | No charge |



Drawer pull-tab handle

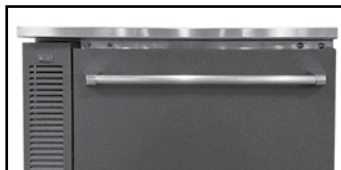

Drawer tube handle



Optional drawers include adjustable divider walls

| TOP STYLE | | | | | |
|-----------------|-------|-------|-------|-------|-----------|
| | 24" | 28" | 36" | 44" | 48" |
| No finished top | | | | | No charge |
| Stainless top | \$440 | \$465 | \$519 | \$575 | \$601 |

| LEFT SIDE FINISH | |
|------------------|-----------|
| Black vinyl-clad | No charge |
| Stainless Steel | \$48 |

| RIGHT SIDE FINISH | |
|-------------------|-----------|
| Black vinyl-clad | No charge |
| Stainless Steel | \$48 |

| BACK FINISH | | | | | |
|------------------|-------|-------|-------|-------|-----------|
| | 24" | 28" | 36" | 44" | 48" |
| Galvanized steel | | | | | No charge |
| Stainless steel* | \$365 | \$377 | \$404 | \$431 | \$446 |

*NOTE: Stainless steel back option also includes stainless steel sides.

| LED LIGHTING STYLE | |
|---------------------------------|-----------|
| Bright white (7,000k), standard | No charge |
| Warm white (3,500k) | No charge |
| Amber (2,700k) | No charge |
| Blue | No charge |

| LEG AND STAINLESS STEEL KICK RAILS | | | | | |
|--|-------|-------|-------|-------|-------|
| NOTE: Legs are required if kick rails are ordered. | | | | | |
| | 24" | 28" | 36" | 44" | 48" |
| 6" legs | \$204 | \$204 | \$204 | \$204 | \$204 |
| Front kick rail | \$127 | \$133 | \$142 | \$153 | \$158 |
| Left side kick rail | \$127 | \$127 | \$127 | \$127 | \$127 |
| Right side kick rail | \$127 | \$127 | \$127 | \$127 | \$127 |

| CASTERS | | | | | |
|----------------|-------|-------|-------|-------|-------|
| | 24" | 28" | 36" | 44" | 48" |
| 4-1/8" casters | \$182 | \$182 | \$182 | \$182 | \$182 |
| 2-7/8" casters | \$176 | \$176 | \$176 | \$176 | \$176 |
| 1-1/2" casters | \$310 | \$310 | \$310 | \$310 | \$310 |



Signature handle



Pull-tab handle



Tube handle

Bar Refrigeration