

*NOTE: Dry Storage Cabinets are manufactured to order and are not returnable.

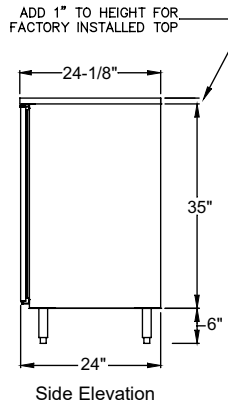

DS24 with stainless door and top

PRODUCT INFORMATION

(see Dry Storage Spec Sheet for complete details)

STANDARD FEATURES:

- Galvanized steel interior construction
- Galvanized steel back

DRY STORAGE CABINETS

MODEL	LIST	LENGTH	DOORS	WEIGHT
DS24	\$2,416	24"	1	140#
DS40	\$4,354	40"	2	255#
DS48	\$4,611	48"	2	265#
DS60	\$5,974	60"	3	365#
DS72	\$6,419	72"	3	380#
DS80	\$7,696	80"	4	475#
DS96	\$8,297	96"	4	495#

Base price only. See below for configurable options.

Select Configurable Options:

DOOR OPTIONS

NOTE: Select options for EACH Door Section

STYLE AND FINISH - PER DOOR

Door - Black vinyl-clad	No charge
Door - Unlaminated	No charge
Door - Stainless steel	\$48
Door - Jeweled stainless	\$252
Door - Laminated	\$288

DOOR HINGE LOCATION - PER DOOR

Left	No charge
Right	No charge

SHELVING

Two adjustable shelves per door included	No charge
--	-----------

DOOR HANDLE - PER DOOR

Signature handle	No charge
Pull-tab handle - stainless or black to match door; black for laminate	No charge
Tube handle	No charge



Signature handle Pull tab handle Tube handle

TOP STYLE

	24"	40"	48"	60"	72"	80"	96"
No finished top				No charge			
Stainless top	\$501	\$546	\$601	\$683	\$764	\$819	\$928

LEFT SIDE FINISH

Black vinyl-clad	No charge
Stainless Steel	\$48

RIGHT SIDE FINISH

Black vinyl-clad	No charge
Stainless Steel	\$48

LEG AND STAINLESS STEEL KICK RAILS

NOTE: Legs are required if kick rails are ordered.

	24"	40"	48"	60"	72"	80"	96"
6" legs	\$204	\$204	\$204	\$305	\$305	\$305	\$305
Front kick rail	\$127	\$145	\$158	\$173	\$190	\$199	\$220
Left side kick rail	\$127	\$127	\$127	\$127	\$127	\$127	\$127
Right side kick rail	\$127	\$127	\$127	\$127	\$127	\$127	\$127

CASTERS

	24"	40"	48"	60"	72"	80"	96"
4-1/8" casters	\$182	\$182	\$182	\$275	\$275	\$275	\$275
2-7/8" casters	\$176	\$176	\$176	\$264	\$264	\$264	\$264
1-1/2" casters	\$310	\$310	\$310	\$464	\$464	\$464	\$464

Bar Refrigeration