



CP1FB72 with compressor left, stainless doors and top

COOLERS - PASS-THRU, ONE ZONE, FRONT SERVICED, BAR PROFILE*

MODEL	LIST	LENGTH	DOOR		WEIGHT	AMPS	HP	LONGNECK	750MLWINE
			DOORS	OPENING				CASES	BOTTLES
CP1FB32*	\$9,383	32"	2	16" w	320#	3.0	1/8	6.6	67
CP1FB36*	\$9,480	36"	2	20" w	325#	3.0	1/8	8.8	79
CP1FB52*	\$12,433	52"	4	16" w	435#	7.0	1/4	14.6	129
CP1FB60*	\$12,816	60"	4	20" w	445#	7.0	1/4	19.1	177
CP1FB72*	\$16,231	72"	6	16" w	580#	7.0	1/4	23.1	209
CP1FB84*	\$16,733	84"	6	20" w	595#	7.0	1/4	29.9	271

Base price only. See next page for configurable options.

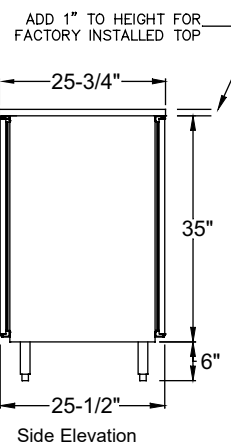

*NOTE: CP1FB coolers are manufactured to order and are not returnable.

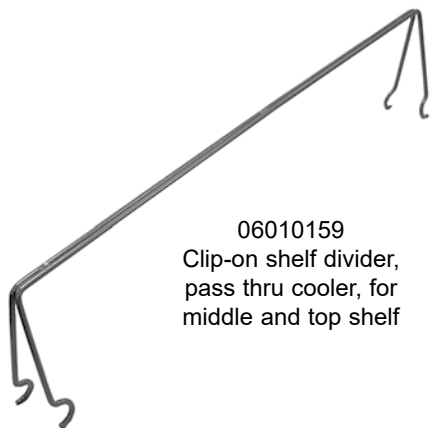

06010159
Clip-on shelf divider, pass thru cooler, for middle and top shelf

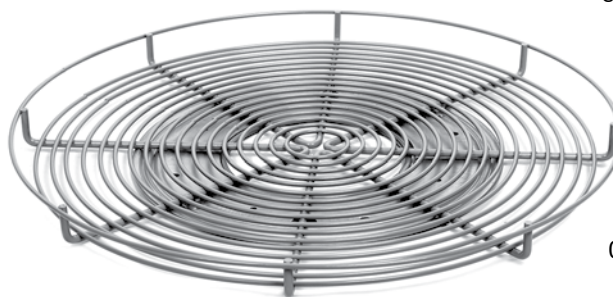

06009785

In a typical cooler, only the front row of bottles is easy to access. Glastender's rotary wine shelf increases access by 270% (16 vs. 6 bottles).

The rotary wine shelf is for use with CP1FB36, CP1FB60, and CP1FB84 model coolers. Two rotary shelves can be used behind each 20" door opening, where they sit on two standard cooler shelves. Each rotary shelf holds up to 29 wine bottles (750ml).

PRODUCT INFORMATION

(see CP1FB Spec Sheet for complete details)

STANDARD FEATURES:

- Self-contained
- All stainless steel interior construction
- Three adjustable coated shelves per section
- Listed to NSF Standard 7 for open food as a storage refrigerator

ACCESSORIES

MODEL	DESCRIPTION	LIST
06009785	Rotary wine shelf (20" door opening ONLY)	\$301
CWS-16P	Wine rack shelf for 16" door opening, 5 bottle	\$196
CWS-20P	Wine rack shelf for 20" door opening, 7 bottle	\$223
06010159	Clip-on shelf divider for middle and top shelf	\$48
06006013	Clip-on shelf divider for bottom shelf only	\$48

Bar Refrigeration

Select Configurable Options:

*NOTE: CP1FB coolers are manufactured to order and are not returnable.

VOLTAGE

120V/60HZ	No charge
220V/50HZ (export voltage)	\$307

TEMPERATURE

Beer / Food, 34° to 40°, standard	No charge
White wine, 50° to 55°	No charge
Red wine, 60° to 65°	No charge

REFRIGERATION COMPARTMENT LOCATION

Left	No charge
Right	No charge

REFRIGERATION COMPARTMENT COVER FINISH

NOTE: Specify and add for both the front and the back

Black vinyl-clad	No charge
Unlaminated	No charge
Stainless steel	\$39
Jeweled stainless steel	\$232
Laminated	\$270

DOOR OPTIONS

NOTE: Select options for EACH Door

STYLE AND FINISH - PER DOOR

Door - Black vinyl-clad	No charge
Door - Unlaminated	No charge
Door - Stainless steel	\$48
Door - Jeweled stainless	\$252
Door - Laminated	\$288
Door - Glass, black vinyl-clad	\$559
Door - Glass, stainless steel	\$607
Door - Glass, jeweled stainless	\$811
Door - Glass, laminated	\$847

DOOR HINGE LOCATION - PER DOOR

Left	No charge
Right	No charge

DOOR HANDLE - PER DOOR

Signature handle	No charge
Pull-tab handle - stainless or black to match door; black for laminate	No charge
Tube handle	No charge

TOP STYLE

	32"	36"	52"	60"	72"	84"
No finished top	No charge					
Stainless top	\$562	\$595	\$728	\$793	\$894	\$991

LEFT SIDE FINISH

Black vinyl-clad	No charge
Stainless Steel	\$48

RIGHT SIDE FINISH

Black vinyl-clad	No charge
Stainless Steel	\$48

LED LIGHTING STYLE

Bright white (7,000k), standard	No charge
Warm white (3,500k)	No charge
Amber (2,700k)	No charge
Blue	No charge

LEG AND STAINLESS STEEL KICK RAILS

NOTE: Legs are required if kick rails are ordered.

	32"	36"	52"	60"	72"	84"
6" legs	\$253	\$253	\$204	\$204	\$305	\$305
Front kick rail	\$137	\$142	\$162	\$173	\$190	\$204
Back kick rail	\$137	\$142	\$162	\$173	\$190	\$204
Left side kick rail	\$127	\$127	\$127	\$127	\$127	\$127
Right side kick rail	\$127	\$127	\$127	\$127	\$127	\$127

CASTERS

	32"	36"	52"	60"	72"	84"
4-1/8" casters	\$223	\$223	\$182	\$182	\$275	\$275
2-7/8" casters	\$220	\$220	\$176	\$176	\$264	\$264
1-1/2" casters	\$387	\$387	\$310	\$310	\$464	\$464



Signature handle



Pull-tab handle



Tube handle

Bar Refrigeration