

| | |
|--------------------------|------------|
| Project: _____ | AIA# _____ |
| Item #: _____ Qty: _____ | SIS# _____ |
| Model #: _____ | |

Extra Deep Ice Bins

See reverse side for model number key



C-IBA-36-CP10-ED

Standard Features

- Extra deep liner for extra ice capacity
- All stainless steel construction
- PVC plastic breaker strip around ice bin liner acts as a thermal barrier to prevent heat transfer
- CFC free foamed-in-place insulation
- Adjustable thermoplastic bullet feet
- Ten circuit available with all 24" and wider models (add suffix '-CP10-ED' to model number)
- Backsplash is an open channel to provide access for beverage lines



Intertek
4004503
Conforms to ANSI/NSF STD 2

NOTE: Ice bins intended to store potable ice must be ordered with an ice bin cover to maintain the sanitation listing.

Specifications

Drain

- Non-cold plate model: 1-1/2" tailpiece
- Ten circuit cold plate model '-CP10': 3/4" MPT

Cold Plate (models with '-CP10' suffix)

- Ten circuit available with all 24" and wider models
- Connection is 5/16" O.D. stainless steel tubing with swaged end

Liner Depth

- 14"

Legs

- 1-5/8" diameter, 16 gauge stainless steel
- Thermoplastic bullet feet

Materials

- 20 gauge stainless steel
- PVC plastic breaker strip around ice bin liner

To view cleaning and care instructions, please visit:
http://www.glastender.com/PDF/F-423-011_ss_clean_care.pdf

Accessories

| | |
|------------|--|
| C-SR-X | Single speed rail, where X is specified as the length in inches. |
| C-DR-X | Double speed rail, where X is specified as the length in inches. |
| IBCA-X | Two-piece, sliding stainless steel cover for 19" (A) deep models, where X is specified as the length of the ice bin in inches. Deduct 6" from cover length for one bottle well and 12" for two bottle wells. |
| BW3 | 3 bottle well for potable ice for 19" (A) deep models. May be positioned left or right. If two are ordered, they are positioned one at each side. |
| BR3 | 3 bottle rack for non-potable ice for 19" (A) deep models. One rack may be ordered for each 6" of ice bin length. Not for use with sliding cover. |
| CCD | Condiment dispenser |
| IBD-H-A-ED | Ice bin divider for 19" (A) extra deep ice bins. |

| | |
|---|-----------------|
| Glastender, Inc. • 5400 North Michigan Road • Saginaw, MI • 48604-9780 989.752.4275 • 800.748.0423 • Fax 989.752.4444 www.glastender.com | Approval/Notes: |
| Specifications subject to change without notice. For current specifications please visit our website. | |

Choice Extra Deep Ice Bins

Dimensional Information

| Model Number | Overall Length | Ice Capacity |
|----------------------------|----------------|--------------|
| C-IBA-18-ED | 18" | 69 lbs |
| C-IBA-24-ED | 24" | 92 lbs |
| C-IBA-30-ED | 30" | 116 lbs |
| C-IBA-36-ED | 36" | 139 lbs |
| C-IBA-42-ED | 42" | 162 lbs |
| C-IBA-48-ED | 48" | 185 lbs |
| With 10-Circuit Cold Plate | | |
| C-IBA-24-CP10-ED | 24" | 92 lbs |
| C-IBA-30-CP10-ED | 30" | 116 lbs |
| C-IBA-36-CP10-ED | 36" | 139 lbs |
| C-IBA-42-CP10-ED | 42" | 162 lbs |
| C-IBA-48-CP10-ED | 48" | 185 lbs |

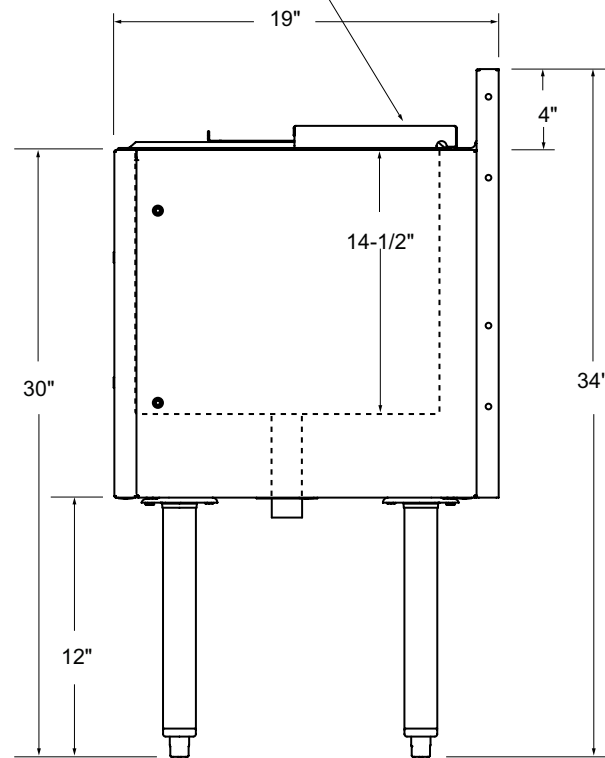
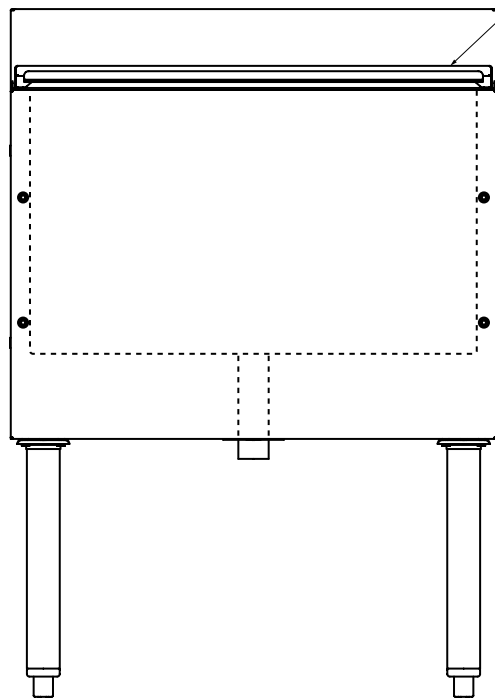
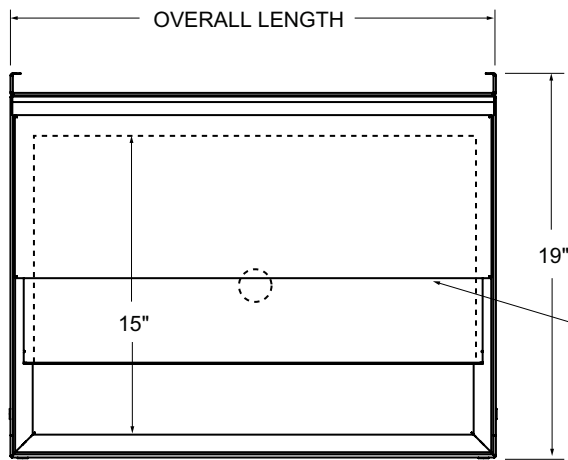

SLIDING COVER
ACCESSORY