

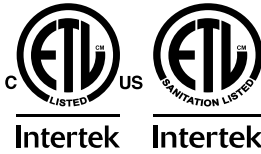

C1FU60 with compressor left, 4" casters, stainless doors and top



4004503
 Conforms to NSF/ANSI STD 7 and UL STD 471
 Certified to CSA STD C22.2 No. 120
 Meets NSF 7 requirements for open food storage

Standard Features

- Stainless steel finished top
- Locking door(s)
- LED interior lighting
- Heated mullion to minimize condensation
- Two adjustable shelves per door
- Doors include stainless steel pull tab handle with lock

Specifications

Electrical

- 120V, 1 phase, 60 Hz
- Full load amps - C1FU32, C1FU36 - 3.0, C1FU52, C1FU60, C1FU72, C1FU84, C1FU92, C1FU108 - 7.0
- Dedicated 15 amp circuit is required
- Includes a 6 foot NEMA 5-15P grounded cord and plug which exits the back of refrigeration compartment



Refrigeration

- R290
- Compressor - C1FU32, C1FU36 - 1/8HP, C1FU52, C1FU60, C1FU72, C1FU84, C1FU92, C1FU108 - 1/4HP
- Heat rejection - C1FU32, C1FU36 - 1228 BTU/Hr, C1FU52, C1FU60, C1FU72, C1FU84, C1FU92, C1FU108 - 2867 BTU/Hr

Operating Range

- 34°F (1°C) to 40°F (4°C)

Project: _____	AIA# _____
Item #: _____ Qty: _____	SIS# _____
Model #: _____	

Coolers One Zone, Front Serviced, Undercounter

C1FU32, C1FU36, C1FU52, C1FU60,
C1FU72, C1FU84, C1FU92, C1FU108

C1FU Configurable Options

Refrigeration Compartment

Location:

- Left or Right

Refrigeration Compartment

Cover Finish:

- Black vinyl-clad
- Unlaminated
- Stainless steel
- Jeweled stainless
- Laminated

Door Style & Finish:

- Door - Black vinyl-clad
- Door - Unlaminated
- Door - Stainless steel
- Door - Jeweled stainless
- Door - Laminated
- Door - Glass, black vinyl-clad
- Door - Glass, stainless steel
- Door - Glass, jeweled stainless
- Door - Glass, laminated

Door Hinge Location (specify for each door):

- Left or Right

Left and Right Side Finish:

- Black vinyl-clad
- Stainless steel
- Laminated

Back Finish:

- Galvanized steel
- Stainless steel

LED Lighting Style:

- Bright white (7,000k)
- Warm white (3,500k)
- Amber (2,700k)

Casters or Legs:

- 4" casters
- 2-1/2" casters
- 6" legs

See our Product Directory for a complete list of cooler accessories.

Glastender, Inc. • 5400 N Michigan Rd • Saginaw, MI • 48604-9780 989.752.4275 • 800.748.0423 • Fax 989.752.4444 www.glastender.com	Approval/Notes:
---	-----------------

Specifications subject to change without notice. For current specifications please visit our website.

Coolers - One Zone, Front Serviced, Undercounter

Dimensional Information

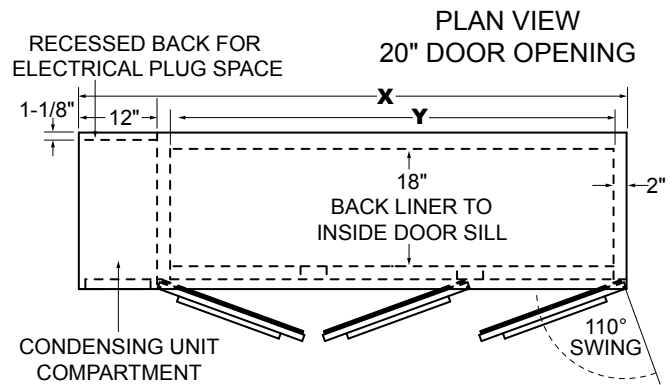
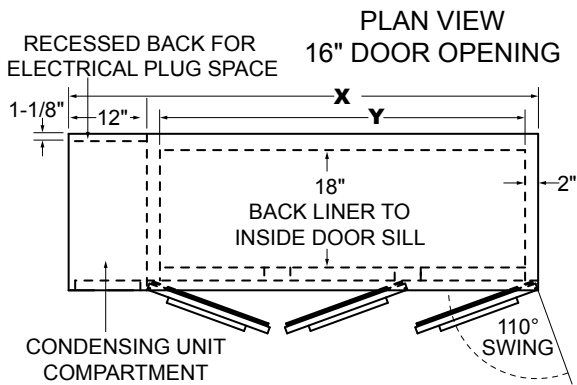

FRONT VIEW 16" DOOR OPENING

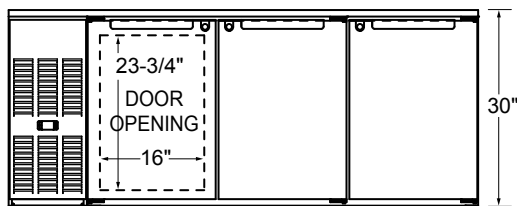

FRONT VIEW 20" DOOR OPENING

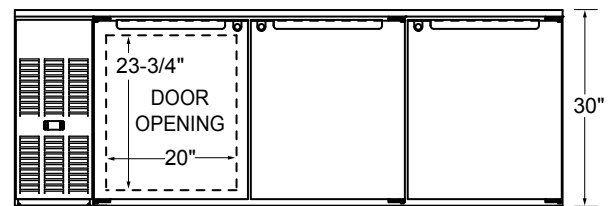

SIDE VIEW 16" DOOR OPENING

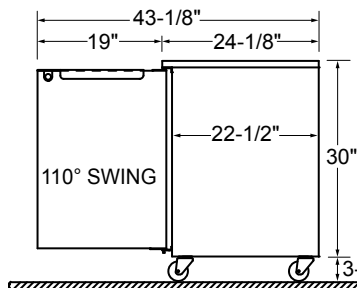

SIDE VIEW 20" DOOR OPENING

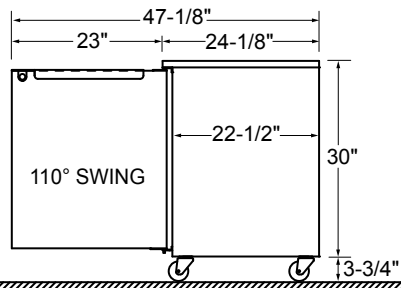

SIDE VIEW

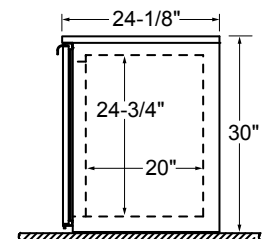

SHOWN WITH OPTIONAL C-4X4 CASTERS. ALSO AVAILABLE WITH 2-1/2" CASTERS OR 6" LEGS.

STANDARD CABINET

Note: Available with compressor left or right. Compressor left model shown.

16" Door Opening Models	X	Y	Doors	Cubic Ft Capacity
C1FU32	32"	16"	1	4.61
C1FU52	52"	36"	2	10.25
C1FU72	72"	56"	3	15.89
C1FU92	92"	76"	4	21.53

20" Door Opening Models	X	Y	Doors	Cubic Ft Capacity
C1FU36	36"	20"	1	5.76
C1FU60	60"	44"	2	12.55
C1FU84	84"	68"	3	19.34
C1FU108	108"	92"	4	26.13



5400 N Michigan Rd • Saginaw, MI • 48604-9780
989.752.4275 • 800.748.0423 • Fax 989.752.4444
www.glastender.com

Printed in USA